

Field gate installation guide

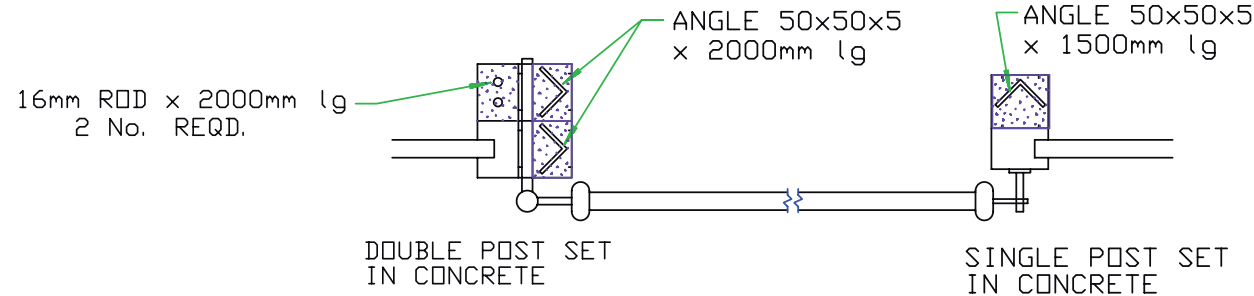

NB
HANGING POST STEELS
SHOULD BE FULL LENGTH
IN POSTS AND CONCRETED
TO THE TOP

EXTERNAL BRACE BARS MADE FROM
50 x 5 FLAT BAR, GALVANIZED &
POWDER COATED & RIVETED TO GATE RAILS

